

# THE FEATHERSTONE BUILDING

FURNISHED + FLEXIBLE



Sixty Six City Road, Old Street EC1

The Featherstone Building is a 126,700 sq ft industrial-inspired workspace with a contemporary finish, located in the heart of the Old Street district. 6,873 sq ft of new **Furnished + Flexible** office space is now available on the second floor.





## Key features

- Situated next to **Old Street Underground** and close to the Elizabeth line accessed via Moorgate
- An **Intelligent Building** that delivers for the digital future
- Beautifully designed **double-height reception** with 7.5m floor to ceiling height
- **Integrated café, DL/ Service** launching autumn 2023 alongside informal collaborative space
- **3.125m floor to ceiling height** on all floors
- Duplex space over ground and lower ground floors of 13,400 sq ft with **Derwent London shared amenity, DL/28** opening autumn 2023
- **Openable windows** throughout and exposed concrete ceilings
- **Communal roof terrace and pavilion** on the 10th floor
- Elegant external architecture using a natural brick palette
- **Concrete core cooling** system allows an industrial aesthetic
- **Lower ground cycle store** for 202 cycle spaces and 84 folding cycles
- 222 **lockers** and 21 **showers**
- Achieved **net zero carbon** construction on completion
- Achieved **EPC** Rating 'A'
- Achieved **WiredScore** Platinum
- Achieved **AirScore Design & Operation** Gold
- Achieved **BREEAM** Outstanding
- Achieved **LEED** Platinum





The Featherstone Building from Bunhill Fields





Second floor: 6,873 sq ft / 639 sq m

- 

50 x fitted desks
- 

1 x 12-person private meeting room  
1 x 10-person private meeting room  
1 x 8-person private meeting room
- 

Town hall / collaboration space  
(with 24 x hot desks)
- 

2 x private phone booths
- 

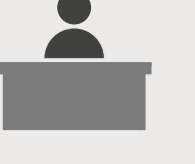
Various breakout spaces
- 

Reception and waiting area
- 

Kitchenette and seating area
- 

On-floor WCs
- 

Cabled and enabled  
with high-speed fibre

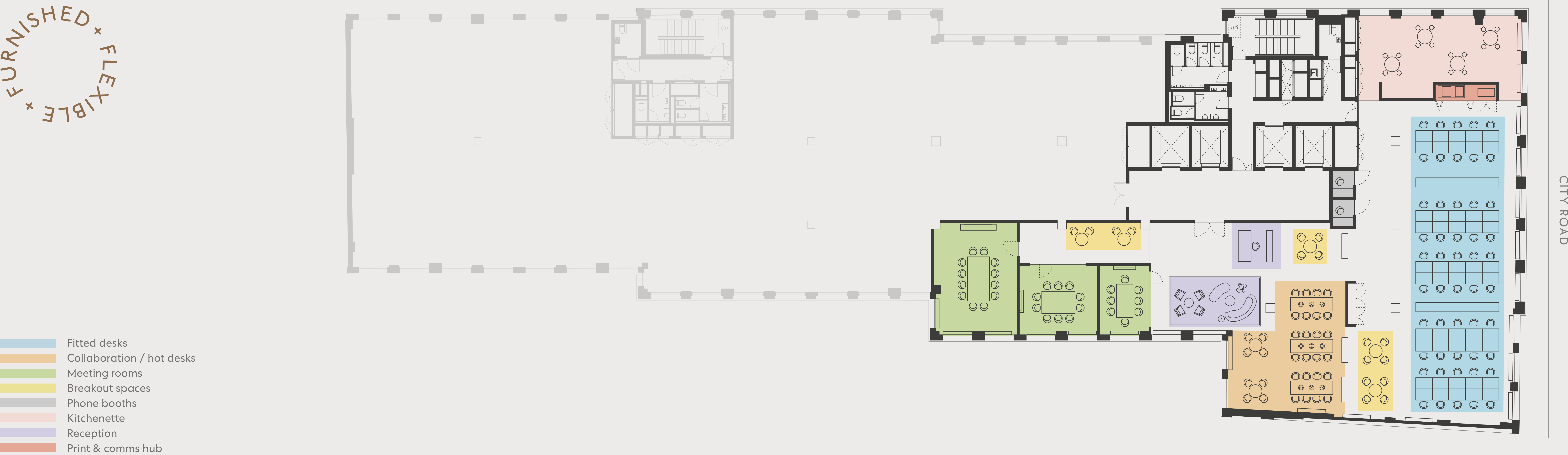





Indicative CGI





Indicative CGI





Indicative CGI



Ground floor: 7,891 sq ft / 733 sq m

FEATHERSTONE STREET



- Reception & café, DL/ Service
- Retail
- Derwent London shared amenity, DL/28
- Loading bay
- Common parts
- Private terrace

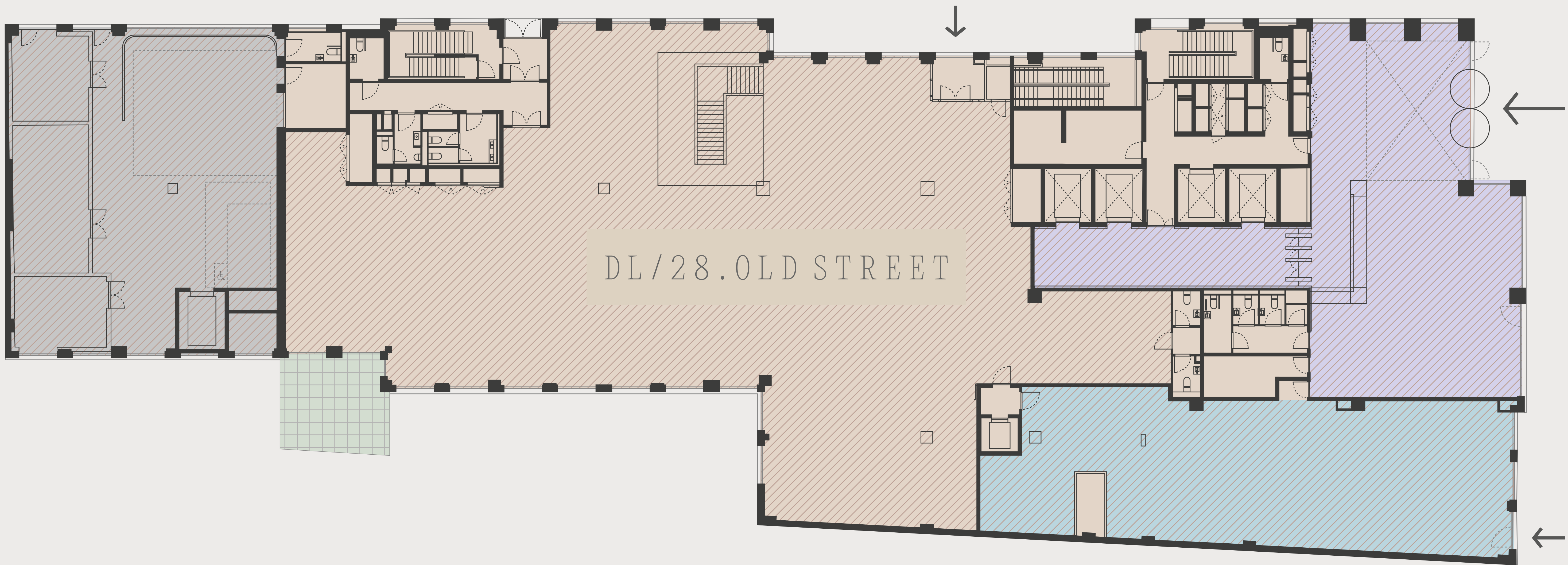

The Featherstone Building entrance on City Road



The Featherstone Building reception



DL/28 Lounge, a hybrid space to work, meet and socialise



Agents

Compton

Shaun Simons  
ss@compton.london  
07788 423 131

Michael Raibin  
mr@compton.london  
07880 795 679

Sarah Hill  
sh@compton.london  
07936 338 774

Knight Frank

Ian McCarter  
ian.mccarter@knightfrank.com  
07940 508 650

William Foster  
william.foster@knightfrank.com  
07748 985 951

Toby Pritchard-Davies  
toby.pritchard-davies@knightfrank.com  
07468 724 284

Tom Harvey  
tom.Harvey@knightfrank.com  
07790 344 111

thefeatherstonebuilding.london

Whilst every effort has been made to ensure accuracy, no responsibility is taken for any error, omission or mis-statement in these particulars, which do not constitute an offer or contract. No representation or warranty whatever is made or given either during negotiations or in particular by the vendor, lessors or agents Messrs Compton and Knight Frank. All figures are exclusive of rates, service charge, VAT and all other outgoings. The agents have not tested the services. All floor areas are approximate.

Date of preparation September 2023

DERWENT  
LONDON



10th floor rooftop pavilion and terrace